

Installation Instructions

INSTRUCTIONS PERTAINING TO A RISK OF FIRE, OR INJURY TO PERSONS.

IMPORTANT SAFETY INSTRUCTIONS. SAVE THESE INSTRUCTIONS.

(Failure to follow the warnings and instructions on this sheet could result in fire, injury, failure of product, and/or voiding of warranty.)

1. Do not touch luminaire while lamp is on. Turn off/unplug and allow to cool before replacing lamp.
2. Lamp gets HOT quickly! Contact only switch/plug when turning on.
3. Do not touch hot lens, body, cap or knuckle.
4. Keep lamp away from materials that may burn.
5. Do not touch lamp at any time. Use a soft cloth. Oil from your skin may damage lamp.
6. Do not operate the luminaire with damaged or missing parts.
7. Do not disassemble luminaire beyond cap removal to facilitate lamp and/or accessory installation or replacement.
8. Remove any debris accumulated in the cap periodically.
9. Do not install luminaire within 10 feet of a pool, spa, or fountain.
10. Have fixture installed in accordance with all applicable installation codes and standards by a person familiar with the construction and operation of the fixture and the hazards involved.
11. Use only cable rated for low voltage. Cable buried more than 6" must be suitable for direct burial. Direct burial cable may be ordered from Vision3 Lighting.

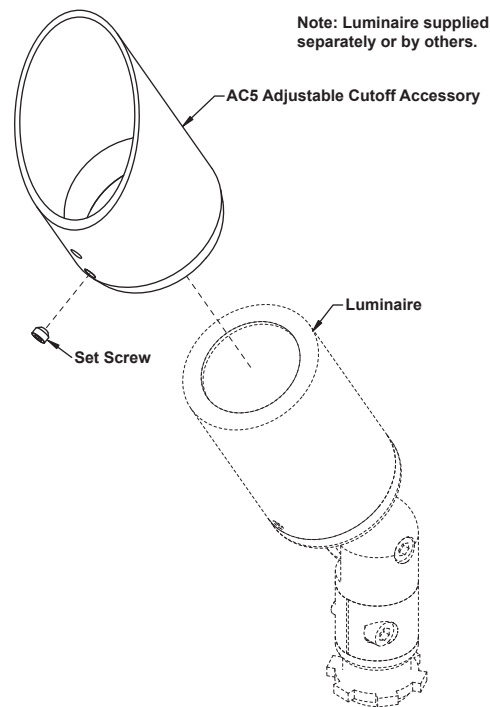

Mount AC5 Adjustable Cutoff Accessory to Luminaire:

1. Caution! Luminaire will be hot if lamp is on.
2. Slide the AC5 Adjustable Cutoff Accessory over the cap on the Luminaire (supplied separately or by others).
3. Adjust AC5 Adjustable Cutoff Accessory to desired position.
4. Tighten the Set Screw to secure the AC5 Adjustable Cutoff Accessory to the Luminaire.

Maintenance:

On a monthly basis:

1. Clean any debris that has collected on the lens.
2. Inspect the drain hole and the gap between the AC5 Adjustable Cutoff Accessory and the Luminaire to ensure that they are not filled with dirt or debris. If they are, water will not drain properly. Remove the AC5 Adjustable Cutoff Accessory and thoroughly clean. Reinstall as described above.